

ESTABLISHING A NEW STANDARD IN THE COMMERCIAL REFRIGERATION INDUSTRY

Smart cooler with product recognition system, featuring Energy efficient and spark-free components, low refrigerant charge and attractive product display.



## KEY FEATURES

- ECO-FRIENDLY HC NATURAL REFRIGERANT
- NEWLY DESIGNED CONDENSER
- SMART ELECTRONIC CONTROL
- ELECTRONIC FAN MOTORS
- LED EFFICIENCY 300+ LUX MINIMUM OUTPUT
- SPARK-FREE REFRIGERATION COMPONENTS
- SMART ELECTRONIC LOCK
- QR PAYMENT APP
- CAMERA INSTALATION KIT

## TECHNICAL SPECIFICATIONS

Exterior dimensions	Internal dimensions	Usable interior capacity
H: 78 7/8"	H: 60 3/8"	H: 52 7/8"
W: 29 1/2"	W: 25 1/2"	W: 24 3/8"
D: 27 7/8"	D: 21 5/8"	D: 19 1/8"

Usable volume	19.29 ft <sup>3</sup>
Doors	1
Door construction	Plastic frame
Shelves	5
External material	Pre-painted steel
Internal material	Pre-painted steel

## CAPACITY DATA\*\*

20 oz bottle capacity	
Total:	200
Facings per shelf:	8
Total per shelf:	40

## REFRIGERATION PERFORMANCE DATA

Refrigerant	R290 2.3oz	
Energy consumption	1.820 kwh / 24 h	
Compressor power	1/3 HP 322 watts	
Condenser	Dynamic	
Thermostat setting default	Cut-out 32°F	Cut-in 44.6°F

## ELECTRICAL DATA

Power supply	115V / 60 Hz
Amps	7.0
Length of cord	128"
Lighting	2 LED Strips
Plug type 	NEMA 5-15P
Controller	Smart Cir 232

## LOGISTIC DATA

Trailer loads	20': 23 40': 42 53': 60
Unit weight w/packaging	240.5 lb
Dimensions w/packaging	H: 82 1/4" W: 32 1/8" D: 29 1/2"

## PRODUCT VIEWS

Front view

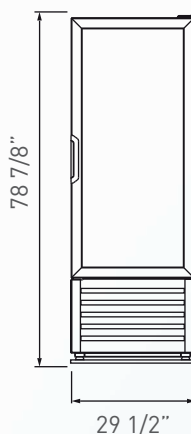

Side view

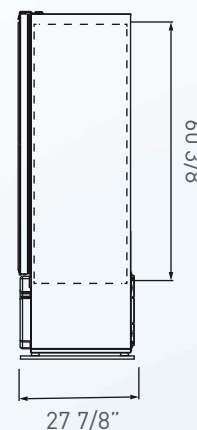

Top view

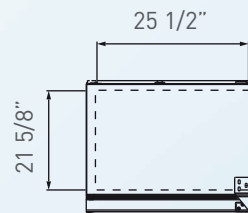

### PRELIMINARY SPEC

- \*Energy consumption based on C condition
- \*BMAD System (Low maintenance high performance)
- \*Dimensions rounded up to the nearest inch or millimeter
- \*Specifications subject to change without notice
- \*H: Height, W: Width, D: Depth
- \*\*Product capacity expressed at its highest level

### Customer service and warranty

Operators must follow installation and operational guidelines per Imbera Users Manual. Each cooler must be connected directly to a single power supply, otherwise warranty will be voided.

03/26/2021